

NOTES (UNLESS OTHERWISE SPECIFIED)

1. SPOT WELD ITEMS 1 AND 2 TOGETHER IN FLAT PATTERN.
2. FORM TO DIMENSIONS REQUIRED AND SPOT WELD AS REQUIRED.
3. SPOT WELD TO BE COMPLETED PER DOC. NO. 'TQ32'.

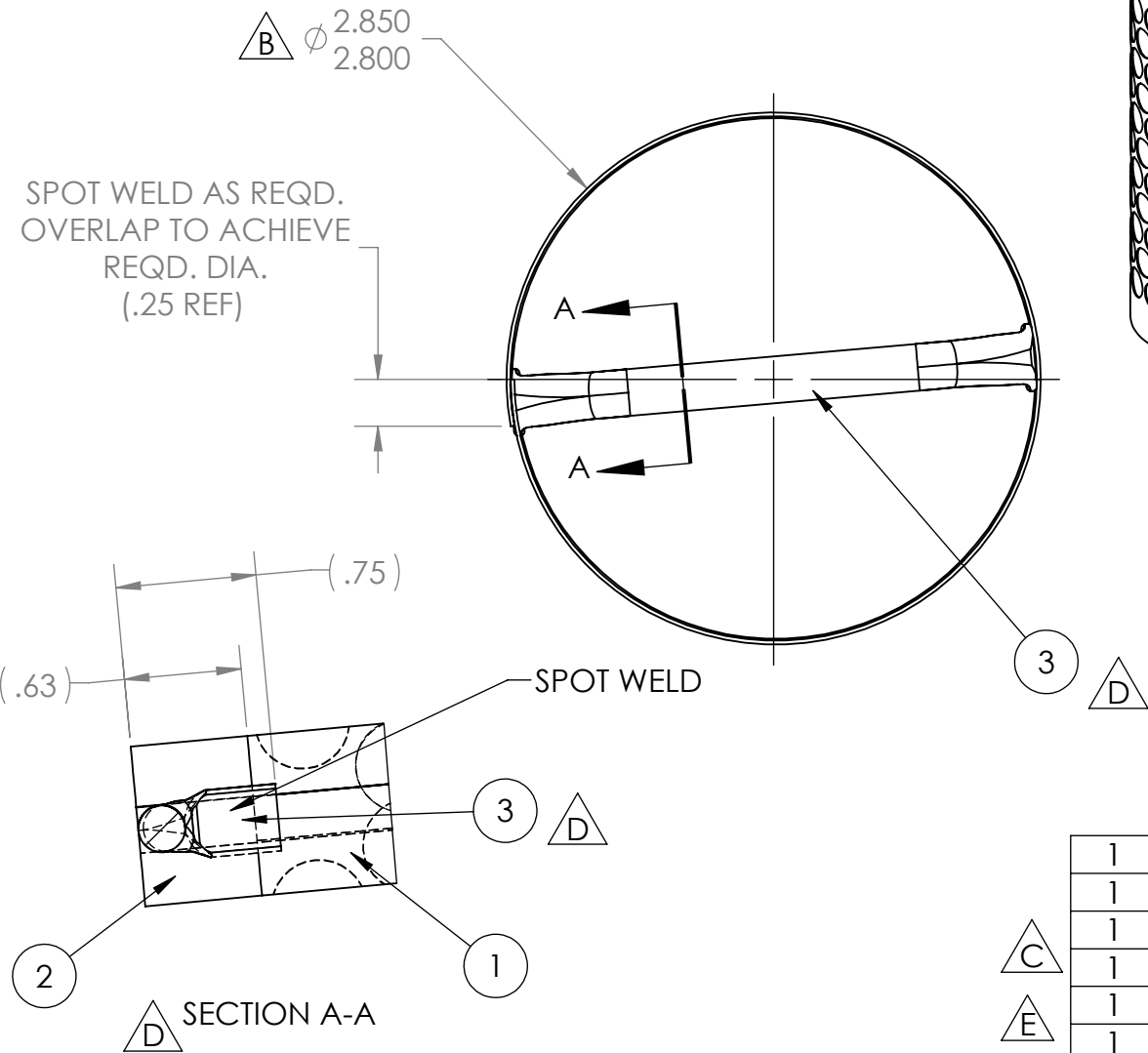
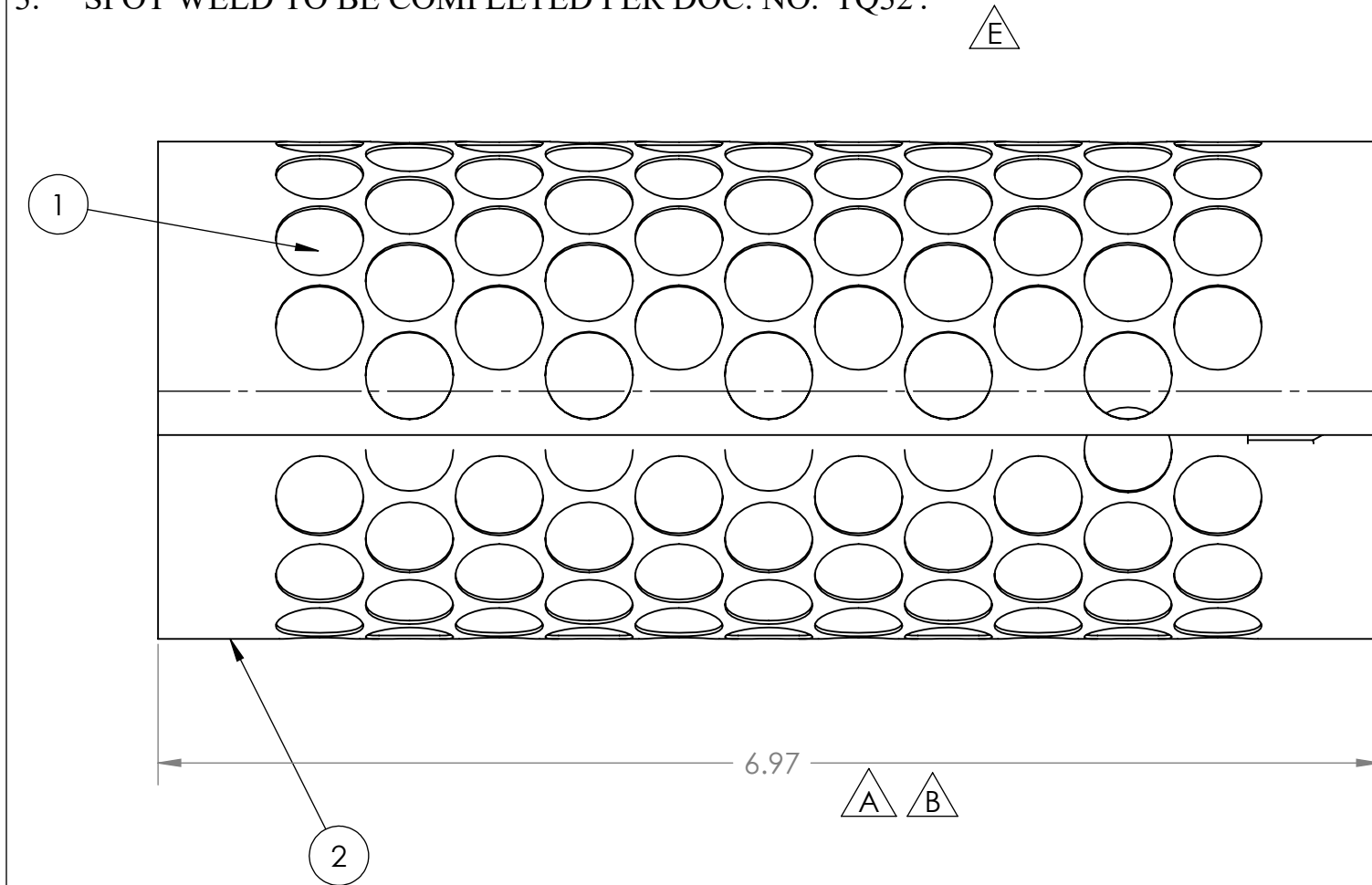

ATTENTION
STC OR PMA CONTROLLED PART

ENGINEERING APPROVED COPY
FOR MANUFACTURE

1	59104	59194
1	59103	59192
1	59059	59190
1	59057	59107
1	59043	59106
1	59026	59105
1	55005	59196

ITEM NO.	PART NO.	NO. REQD	DESCRIPTION	SIZE	SPEC.	NO. REQD	NEXT ASSEMBLY	FINAL ASSEMBLY
3	19530	1	SCREEN HANDLE			1	FINAL ASSEMBLY	59022
2	14836	1	SCREEN			1		59008
1	13996	1	SCREEN - 30 MESH		COMMERCIAL	1		50849

REV.	E.O.#	DESCRIPTION	BY	DATE	APPR'D	DATE
F	10335	ADDED TRIMETRIC VIEW TO SHOW WHERE ITEM NO. 3 IS LOCATED	RC	5/16/2017	CLK	5/17/17
E	6440	ALL GENERAL NOTE NO. 3; UPDATED FINAL ASSEMBLY LIST	KGR	4/8/2015	CLK	4/8/15
D	3741	ADDED ITEM 3 P/N 19530 QTY 1 & SECTION "A-A"	PK	12/20/2012	JMV	12/20/12
C	1535	ADDED 59043 TO NEXT ASSY	PK	7/7/2011	JMV	7/7/11
B	0777	DIM 6.97 WAS 8.38 ; DIA 2.850/2.800 WAS 2.86/2.85	JMV	12/21/2010	JMV	12/21/10
A		8.38 WAS 7.00	CS	4/24/09	CS	4/24/09
NC		INITIAL RELEASE	MdG	1/16/06	MDG	1/16/06
REV.	E.O.#	DESCRIPTION	BY	DATE	APPR'D	DATE

UNLESS OTHERWISE SPECIFIED:
DIMENSIONS ARE IN INCHES

TOLERANCES:
FRACTIONS ±1/16
.XX ±.03
.XXX ±.010
ANGLE ± 1/2°

HOLE DIA:
.0135 - .125 DIA. +.004 -.001
.1260 - .250 DIA. +.005 -.001
.2510 - .500 DIA. +.006 -.001
.5010 - .750 DIA. +.008 -.001
.7510 - 1.000 DIA. +.010 -.001

REMOVE ALL BURRS AND SHARP EDGES
INTERPRET DRAWING PER ANSI Y14.5M-1982
SURFACE ROUGHNESS PER MIL-STD-10
ALL MACHINED SURFACES NOT TO EXCEED 63
MICROINCHES PER MIL-STD-10 UNLESS NOTED

SolidWorks

TRANSLAND

1206 HATTON ROAD, WICHITA FALLS, TX 76302

TITLE: **ASSEMBLY - SCREEN 30 MESH**

SIZE **B** DWG. NO. **29530** **F**

SCALE: NTS MODEL: S2R SHEET 1 OF 1