

NOTES (UNLESS OTHERWISE SPECIFIED)
1.

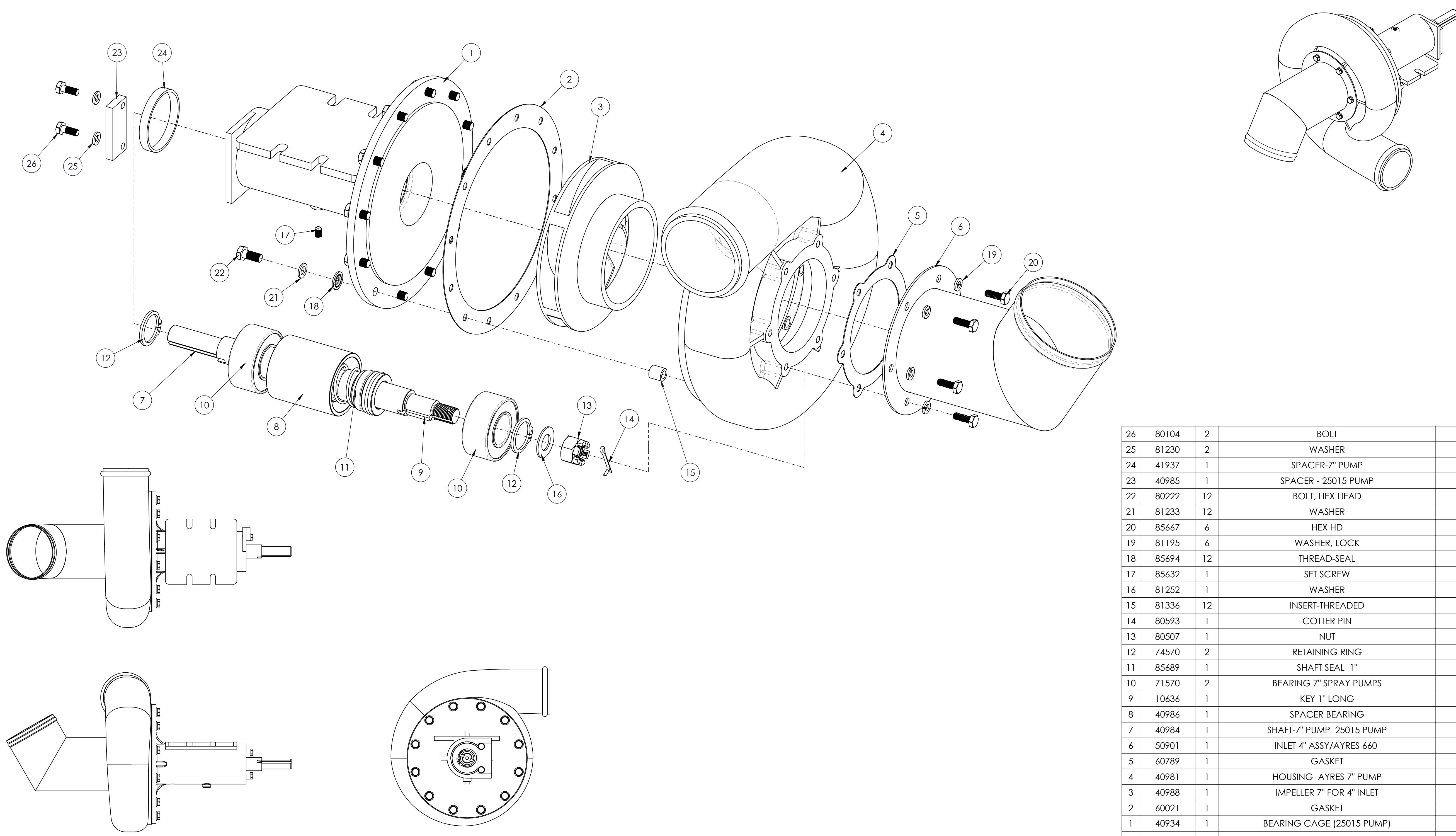

26	80104	2	BOLT							
25	81230	2	WASHER							
24	41937	1	SPACER-7" PUMP							
23	40985	1	SPACER - 25015 PUMP							
22	80222	12	BOLT, HEX HEAD							
21	81233	12	WASHER							
20	85667	6	HEX HD							
19	81195	6	WASHER, LOCK							
18	85694	12	THREAD-SEAL							
17	85632	1	SET SCREW							
16	81252	1	WASHER							
15	81336	12	INSERT-THREADED							
14	80593	1	COTTER PIN							
13	80507	1	NUT							
12	74570	2	RETAINING RING							
11	85689	1	SHAFT SEAL 1"							
10	71570	2	BEARING 7" SPRAY PUMPS							
9	10636	1	KEY 1" LONG							
8	40986	1	SPACER BEARING							
7	40984	1	SHAFT-7" PUMP 25015 PUMP							
6	50901	1	INLET 4" ASSY/AYRES 660							
5	60789	1	GASKET							
4	40981	1	HOUSING AYRES 7" PUMP							
3	40988	1	IMPELLER 7" FOR 4" INLET							
2	60021	1	GASKET							
1	40934	1	BEARING CAGE (25015 PUMP)							
ITEM NO.	PART NO.	NO. REQD	DESCRIPTION	SIZE	SPEC.	NO. REQD	NEXT ASSEMBLY	FINAL ASSEMBLY		
			MATERIAL							

NAME	DATE	UNLESS OTHERWISE SPECIFIED: DIMENSIONS ARE IN INCHES	 1206 HATTON ROAD, WICHITA FALLS, TX 76302 TITLE: SPRAY PUMP ASSY/7" AYRES 660
DRAWN	RC 8/7/17	TOLERANCES: FRACTIONS ±1/16 XX ±.03 XXX ±.010 ANGLE ±1/2°	
CHECKED	CLK 8/7/17	HOLE DIA: .125 - .125 DIA. +.004 -.001 .1260 - .250 DIA. +.005 -.001 .2510 - .500 DIA. +.006 -.001 .5010 - .750 DIA. +.008 -.001 .7510 - 1.000 DIA. +.010 -.001	
ENG APPR.	RR 8/7/17	REMOVE ALL BURRS AND SHARP EDGES INTERPRET DRAWING PER ANSI Y14.5M-1982 SURFACE ROUGHNESS PER MIL-STD-10 ALL MACHINED SURFACES NOT TO EXCEED 63 MICROINCHES PER MIL-STD-10 UNLESS NOTED	
SolidWorks		THIRD ANGLE PROJECTION	SIZE DWG. NO. 28660 REV NC SCALE: NTS MODEL: SHEET 1 OF 1

**ENGINEERING APPROVED COPY
FOR MANUFACTURE**

REV.	E.O.	DESCRIPTION	BY	DATE	APPR'D	DATE
NC	10899	INITIAL RELEASE	RC	8/7/2017	CLK	8/7/2017
REVISIONS						