

- NOTES (UNLESS OTHERWISE SPECIFIED)**
- ITEM 4 CAN BE REPLACED WITH PARTS IN OPTION TABLE AS CUSTOMER REQUEST.
 - ITEMS MAKE UP INLET P/N 55162.

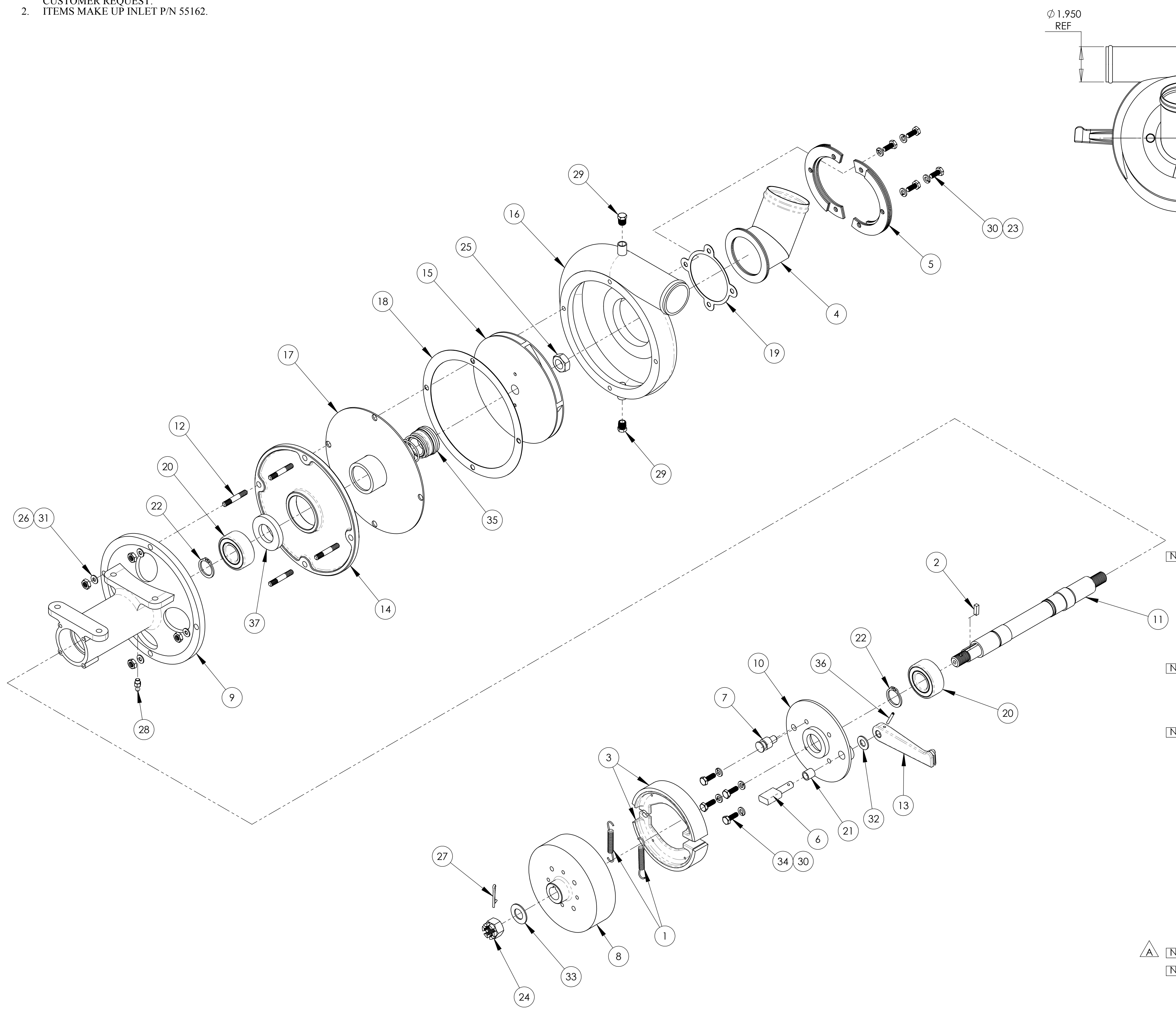

OPTION TABLE FOR ITEM 4

PART NO.	DESCRIPTION
24060	2 1/2" HOSE 30°
24061	2 1/4" HOSE 30°
24062	2" HOSE 45°
24063	2 1/4" STRAIGHT HOSE
24064	2" STRAIGHT HOSE
24065	2 1/2" STRAIGHT HOSE
24066	3" STRAIGHT HOSE
24067	2" HOSE 60°
24068	2 1/4" HOSE 60°
24069	2 1/2" HOSE 60°
24070	3" HOSE 60°
24073	2" HOSE 30°
24074	3" HOSE 30°

37	86176	1	SEAL
36	85726	1	SPRING PIN
35	85690	1	SHAFT SEAL
34	85667	4	SCREW
33	81252	1	WASHER, FLAT
32	81237	1	WASHER, FLAT
31	81233	4	WASHER, FLAT
30	81195	8	WASHER, LOCK
29	81175	2	PIPE PLUG
28	80603	1	GREASE FITTING
27	80593	1	COTTER PIN
26	80563	4	NUT
25	80524	1	NUT, CHECK
24	80617	1	NUT, CASTLE
23	80104	4	BOLT, HX HD
22	74568	2	SNAP RING
21	71590	1	BUSHING
20	71548	2	BEARING
19	60842	1	GASKET
18	60662	1	GASKET
17	51926	1	SEAL CUP ASSY
16	51785	1	VOLUTE ASSY
15	50782	1	IMPELLER
14	44362	1	BACK PLATE
13	40911	1	BRAKE ARM
12	40804	4	STUD, VOLUTE
11	40797	1	SHAFT
10	40787	1	END PLATE
9	40785	1	BEARING HOUSING
8	40641	1	BRAKE DRUM
7	40368	1	POST
6	40367	1	CAM
5	34071	2	MOUNTING PLATE ASSY
4	24069	1	TUBE ASSY
3	20503	2	BRAKE SHOE ASSY
2	10632	1	KEY
1	10596	2	SPRING

REV.	E.O.	DESCRIPTION	BY	DATE	APPR'D	DATE
C	10807	CHANGED ITEM 17 51921 TO 51926	LA	7/12/2017	CK	7/17/17
B	9401	CHANGED ITEM 35 85689 TO 85690	RC	10/20/2016	CLK	10/24/2016
A	1819	ITEM 5 P/N 34071 WAS 24071, FOR ITEM 4: ADDED NOTE 1 & OPTION TABLE	PK	9/7/2011	JMV	9/8/2011

REVISIONS

ENGINEERING APPROVED COPY
FOR MANUFACTURE

NAME: JMV DATE: 4/26/10
 CHECKED: RR 7/17/17
 ENG APPR: CLK 7/17/17

UNLESS OTHERWISE SPECIFIED:
 DIMENSIONS ARE IN INCHES
 TOLERANCES:
 FRACTIONS ± 1/16
 DECIMALS ± .005
 ANGLES ± 1/2°

REMOVE ALL BURS AND SHARP EDGES
 INTERPRET DRAWING PER ANSI Y14.5M-1982
 SURFACE ROUGHNESS PER MIL-STD-10
 ALL MACHINED SURFACES NOT TO EXCEED 40 MICRONS PER MIL-STD-10 UNLESS NOTED

SolidWorks

TRANS-LAND
 1206 HATTON ROAD, WICHITA FALLS, TX 76302

TITLE: 6-1/2" SST PUMP

SIZE DWG. NO. **51869** REV **C**

SCALE: NTS MODEL: SHEET 1 OF 1